

# Kv. Arken 1

## 5 RoK (E2)

Lägenhet: 1157-001-01-1101  
1157-001-01-1201

Plan: 1-2

Boarea: 110,2m<sup>2</sup>

(Boarea inkluderar innerväggar, enligt Svensk Standard, areaavvikelser kan förekomma.)









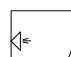

### FÖRKLARINGAR

Takhöjder:

- i lägenhet: 2,50 m

- i klk & dusch/tvätt: 2,30 m

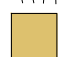
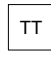
lokala sänkningar kan förekomma

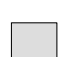
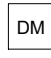
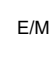
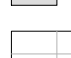
 K	Kyl	 G	Garderob		Duschdraperiskena
 F	Frys	 ST	Städsåp		Hatthylla
 	Spis	 L	Linnesåp		Parkett
 TT	Torktumlare	 TM	Tvättmaskin		Plastmatta
 DM	Diskmaskin	 E/M	EI/Mediaskåp		Klinker

Multimediauttag finns i samtliga lägenheter på flertalet ställen.

Reservation för att avvikelser kan förekomma.

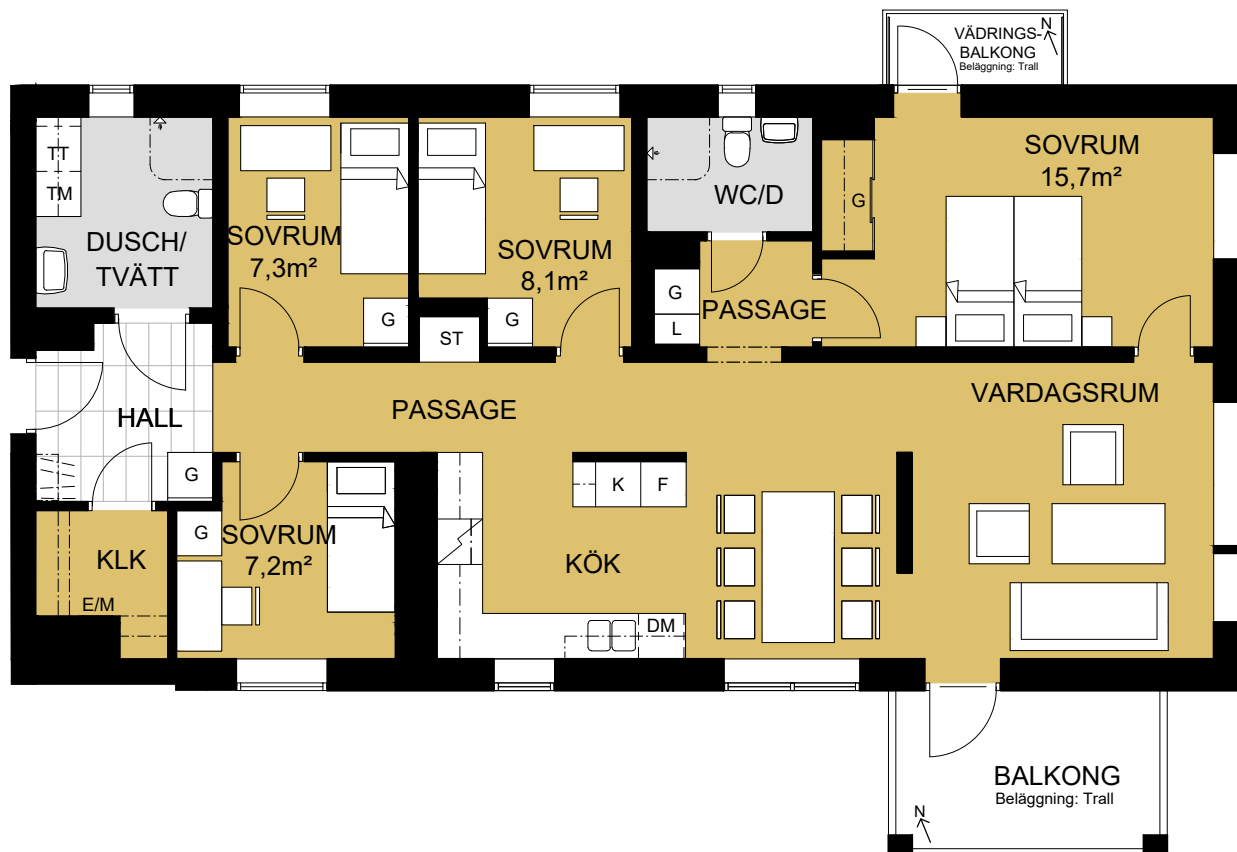

### ORIENTERINGSPLAN

Adress: Serafimervägen 3A

Plan: 1-2

 = Lägenhetens placering i huset

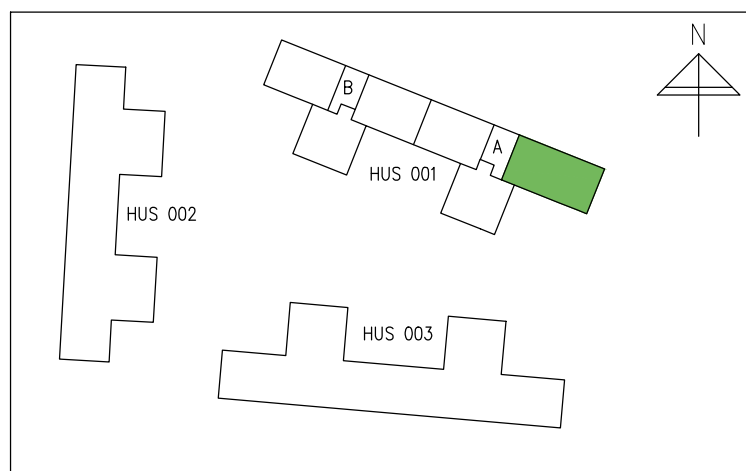

SKALA 1:100 (A4-format)

