

Kv Pilgrimen 2

1 RoK (A2)

Lägenhet : 1116-001-02-1502

Plan: 6

Boarea: 45,4m² Total golvyta: 52,9m²













(Boarea och total golvyta inkluderar innerväggar, enligt Svensk Standard, areaavvikelser kan förekomma.)

FÖRKLARINGAR

Takhöjder:

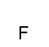
- i lägenhet: 2,40 m

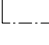
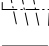
snedtak förekommer samt lokala sänkningar kan förekomma

	Kyl/frys-skåp
	Spis
	Städs-kåp
	Garderob
	Diskmaskin
	Tvättmaskin
	Torktumlare
	Hyllplan
	Fördelarskåp
	EI/Mediaskåp
	Duschdraperiskena
	Hatthylla
	Parkett
	Plastmatta
	Klinker

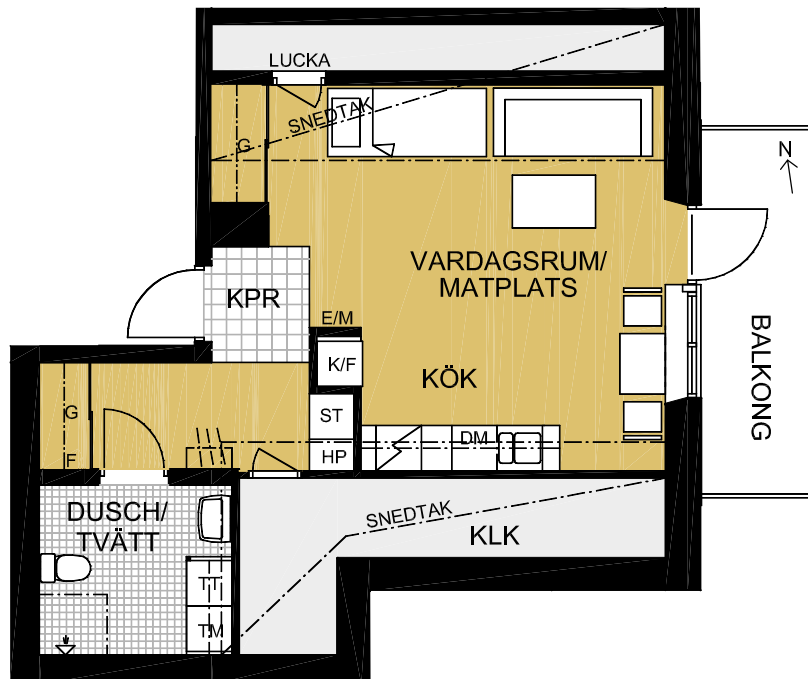

ORIENTERINGSPLAN

Adress: Södra Järnvägsgatan 4G

Plan 6

 = Lägenhetens placering i huset

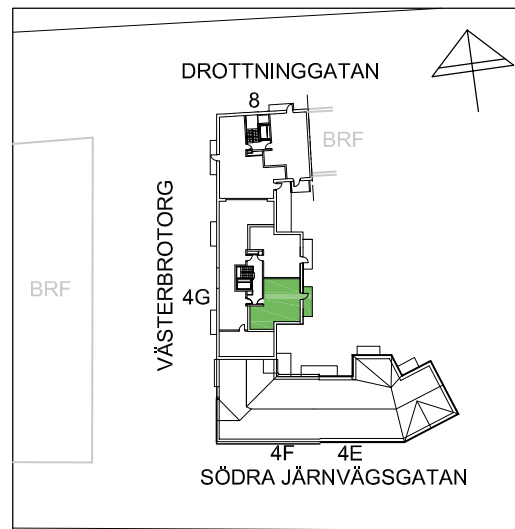

Multimediauttag finns i samtliga lägenheter på flertalet ställen.

Reservation för att avvikelser kan förekomma.

SKALA 1:100 (A4-format)

